



Serial Number

--

Table of Content

Introduction -----	2
Important Precautions -----	3
Safety Warning & Instruction Labels -----	4
Identification of Parts -----	5
Charging the Batteries -----	9
Disassembling your Scooter -----	10
Troubleshooting -----	11
Caution -----	12
Safety Information on Electromagnetic Interference (EMI) -----	13
Care and Maintenance -----	15
Specifications -----	16
Warranty -----	17

Thank you and congratulations on purchasing your new Abilize Mobility Scooter.

It is designed to provide you with transportation ability indoors and outdoors.

We pride ourselves on providing safe and comfortable products. Our goal is to ensure your complete satisfaction. We sincerely hope you enjoy your Abilize Mobility Scooter.

Please read and observe all warnings and instructions provided in owner's manual before you operate the various functions of this scooter. Also, please retain this booklet for future reference.

IF YOU HAVE ANY QUESTIONS, YOU CAN CONTACT:

UK Authorised Dealer

CareCo (UK) Limited,
1 Turing Court,
Great Notley,
Braintree,
CM77 7AT

0333 015 5000

www.CareCo.co.uk

Information of European Representation

MedNet EC-REP GmbH
Borkstrasse 10,
48163 Muenster,
Germany

UKRP MediMap Ltd, 2 The Drift,
Thurston, Suffolk, IP31 3RT



CareCo (UK) Limited,
1 Turing Court, Great Notley,
Braintree, CM77 7AT



Instruction Booklet: Important Precautions

- Only one person at a time can ride the Scooter.
- Maximum load is 136 kg / 300 lbs pounds.
- Turn key off before getting on or off.
- Always drive carefully and be aware of others using the same area.
- Always use pedestrian crossings wherever possible. Take extreme care when crossing roads.
- Do not drive on slope exceeding 8 degree, and take extreme care when turning on slope.
- Do not use full power when turning to sharp corner.
- Take great care and drive in low speed when backing up, riding downhill or on uneven surface, and climbing curb.
- Please use the lowest speed when driving through a descending road or uneven terrain. If speed is too fast, leave your hand off the handle bar, let the scooter stop. Make sure you are safe and start again.
- The weight capacity limit can be different depending on ramp degree.
- A slow speed must always be used when ascending, descending or traversing a slope or incline and also on uneven terrain, ramps and soft or loose surfaces, such as gravel or grass.
- To prevent any danger, do not turn around at high speed while ascending or descending a ramp.
- Scooter may not operate well in high humidity.
- Do not leave the powered scooter in a rain storm of any kind.
- Direct exposure to rain or dampness will cause the scooter to malfunction electrically and mechanically; may cause the powered scooter to prematurely rust.
- Never put scooter in neutral when staying on slopes.
- Follow traffic laws when riding outside.
- When scooter is on moving transport vehicles, do not sit or stay on scooter.



<p>1</p>	<p>Warning Sticker</p> <ol style="list-style-type: none"> 1. Please read the instruction booklet carefully before using your scooter. 2. Do not drive the scooter on slippery surfaces or on slopes over 8 degrees limit. 3. Do not drive on highway, crowded roads, or unfamiliar areas. 4. Do not turn at high speed in either forward or reverse. 5. Do not wash with water or leave scooter in humid environment since water can damage the electronic parts. 6. Release the emergency handbrake strap after use. 	
<p>2</p>	<p>Power warning label</p>	<p>7</p> <p> REF Model Number MD Medical Device SN Serial Number Date of Manufacture Manufacturer Importer EC REP EU Authorized representative WEEE Conformity Consult Instructions for Use UK CA UK Conformity Assessed Warning UKRP UKRP CE European Conformity Max: Maximum weight capacity </p>
<p>3</p>	<p>Instruction of battery lock nut label</p>	
<p>4</p>	<p>Wiring diagram Label</p>	
<p>5</p>	<p>Warning label Keep hands away</p>	
<p>6</p>	<p>Instruction label Dismantling the front and rear frame of scooter</p>	<p>8</p> <p>N-D Lever Adjustment label which instructs freewheel mode operation.</p>

Instruction Booklet: Identification of Parts

Before attempting to drive this scooter on your own, it is important that you familiarize yourself with the controls and how to operate them.



Figure 1 - Front View

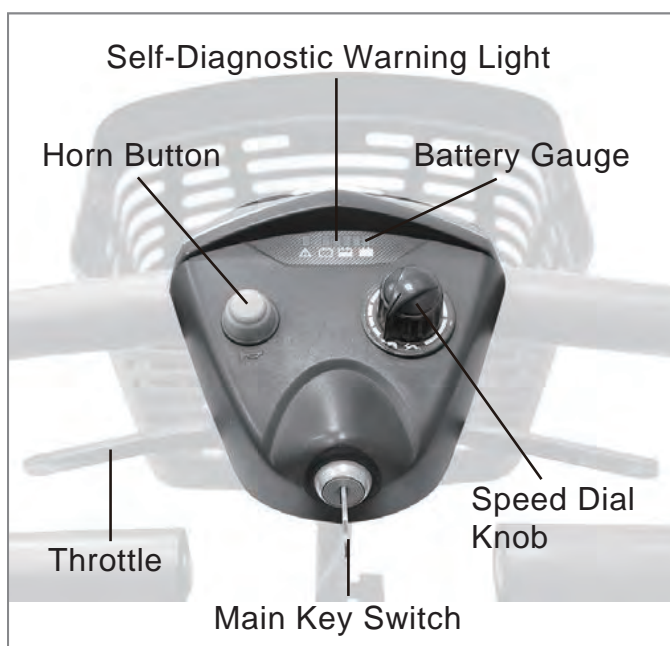

Figure 2 - Top Control Panel



Figure 3 - Back View

Before operation, please remove the Lock Nut (A) and press button of Circuit Breaker (B) to activate the system.

Function of Parts:

Main Key Switch (C)

- Turn the key to the right to turn the scooter on.
- Turn the key to the left to turn the scooter and LED light on.
- Turn the key to the centre position to turn the scooter off.

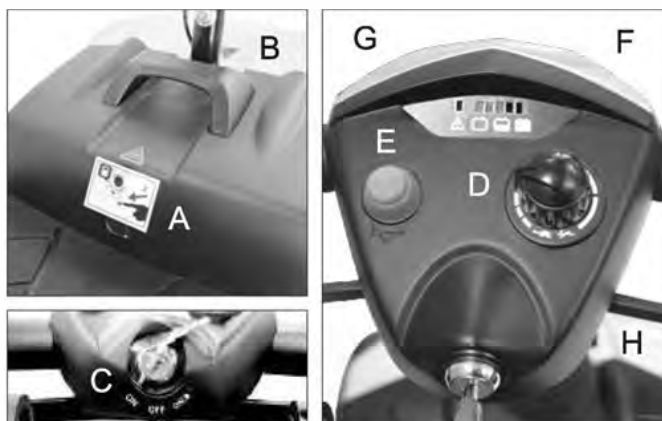

CAUTION: Always ensure that the scooter is switched off before getting on or off the scooter and before removing any items of the scooter.

CAUTION: Turning the scooter OFF whilst driving will bring the scooter to an abrupt stop.

Speed Dial Knob (D)

The rabbit icon indicates fast or high speed. The turtle icon indicates slow or low speed. By turning this Knob (D) towards chosen icon you can control the overall speed of the scooter.

CAUTION: Before driving the scooter, set the speed to low speed by turning the knob towards turtle icon.

CAUTION: Drive in high speed when encounter an up slope, and drive in low speed when encounter a down slope.

Horn Button (E)

Press Horn Button (E) once to sound warning tone when necessary.

Battery Gauge (F)

The LEDs represents an approximation of battery capacity. If the charge is full, all LEDs are lit. When only red and orange LEDs are lit, the batteries are consuming and should be charged soon. When only red LEDs are lit, charge the batteries immediately.

Self Diagnostic Warning Light (G)

Flashing light indicates there is a problem within scooter. See page 11 for more information.

Throttle (H) (H1)

To move forward by pulling the right side of Throttle (H). To move backward by pulling the left side of Throttle (H1). (The movement directions can be reversed by local dealers if required.) Releasing the throttle to engage automatic brake. These are also your accelerator, the further you pull it, the faster you go. (Subject to the position of the RabbiUTurtle control).

CAUTION: Releasing the throttle engages the automatic brake, but will taxi for a short buffering distance, please keep safe distance when stopping to prevent any danger.

Instruction Booklet: Identification of Parts

Tiller Angle Adjustment :

- Turn the Cap (I) outward upward to disengage the pin.
- Simultaneously, adjust the tiller fore-and-aft to the most comfortable angle. Release Cap (I) and ensure the pin is fully engaged to lock the tiller in position.

Seat Rotation Adjustment :

- Lift the Lever (J) upward to disengage the pin.
- Simultaneously, rotate Seat (K) to the most comfortable angle. To lock the seat in position by Releasing Lever (J) and ensure the pin is fully engaged.



Circuit Breaker :

If scooter's circuit system malfunctions or over loaded, the circuit breaker will trip and automatically shut down the power to ensure driver's safety. After shut down the power, press button of Circuit Breaker (B) to reactive the circuit system.

Free-Wheeling Lever :

The scooter can be pushed, when the Free-Wheeling Lever (L) is disengaged. To engage the Free-Wheeling Lever (L) - Pull up the free-wheeling lever.
To disengage the Free-Wheeling Lever (L) - Push down the free-wheeling lever.

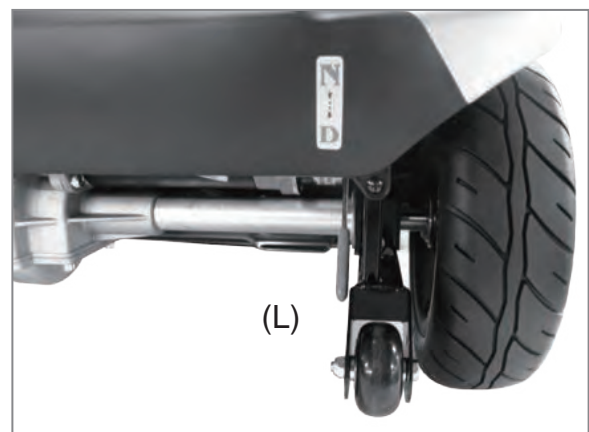
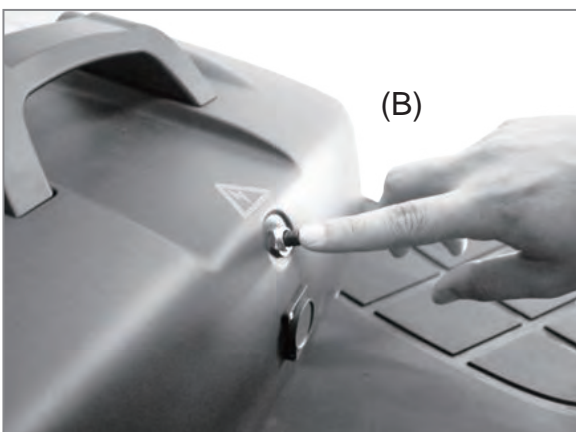

Basket assembling and disassembling :

- Place the Front Basket (M) to the bracket on the tiller.
- Remove the Front Basket (M) and place it aside.

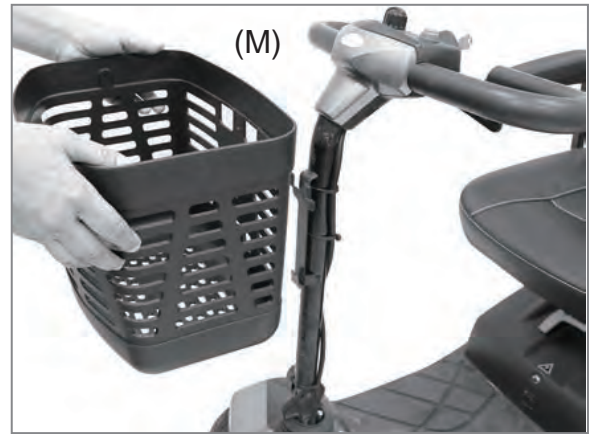

Armrest assembling and angle adjustment :

- Adjust armrest to most comfortable length, then lock the Knob (N).
- Adjust Screw (O) height to preferable armrest's angle.

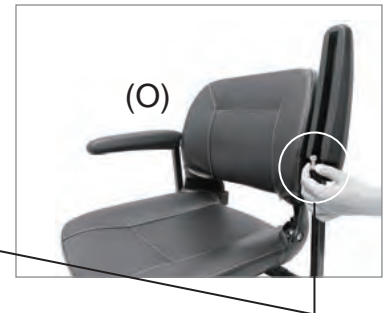

Seat height adjustment :

- Remove the seat, then screw, nut and washer from seat post.
- Adjust seat post to desired height, then attached tightly with screw, nut and washers.
- Assemble the seat back to its original position.
- Seat height adjustable 520mm / 545mm / 570mm.

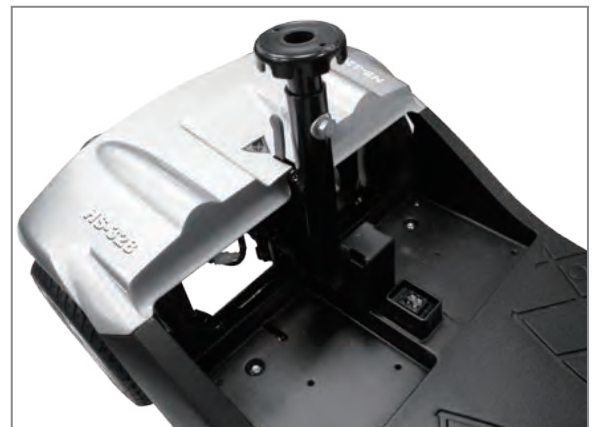
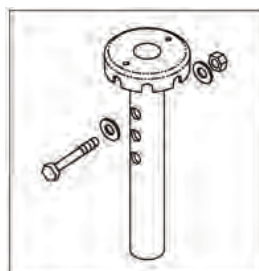

Instruction Booklet: Charging the Batteries

Your Aeron scooter is equipped with One, maintenance free 25.2V. 30.15Ah. Rechargeable batteries and one 4A charger. Batteries must be charged before using scooter for first time and should be recharged after each day's use. Be sure power switch is in OFF position and free-wheeling lever is not in freewheel mode.

For safety reasons, IATA Packing Instructions, and IATA Provision A67 shall be installed in the scooters. If you need new batteries, contact your dealer. Only 25.2V. 30.15Ah. Valve-regulated Lithium batteries should be used.

- Insert battery charger cord into Charging Socket (P) on battery pack.

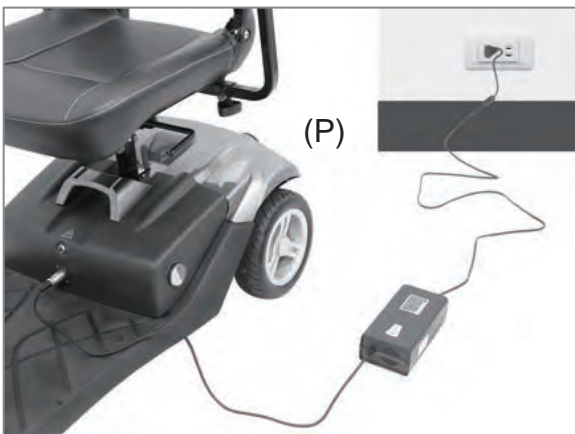

- Plug other end of Power Cable (Q) into a standard electrical wall outlet.
- LED Indication
LED (Power) - RED Light on: Power on LED (Charge) - ORANGE Light on : Charging
GREEN Light on : Fully charged
- Allow batteries to charge until charging indicator turns green. For optimum performance a first initial charge of 24 hours is recommended and 12 hour charge after every use.
- After indicator turns green, unplug battery charger from scooter and wall outlet.
- If at any time battery charger light flashes green over 40 minutes, this indicates abnormal **charging occurred. You should check the following :**
 1. Charger plug is correctly positioned.
 2. Scooter is turned off.
 3. If none of these are the problems, contact your local authorized dealer.

CAUTION: The time needed to recharge will vary depending on the depletion of the batteries. Charging for longer than necessary will not harm the batteries. They can not be overcharged.

1. Seat Disassembling :

Remove seat by lifting Seat Rotation Lever (J). Then rotate Seat (K) and lift up away from scooter.

2. Battery Pack Disassembling :

As indication, pull Battery Pack Handle (R) to remove Battery Box (S) from scooter.

Caution : Battery Box is heavy. When lifting, please use correct lifting posture to avoid injury. Ask for assistance if necessary.

CAUTION : When assembling battery pack (S), make sure to aim for the battery terminal connection for proper electricity conductivity.

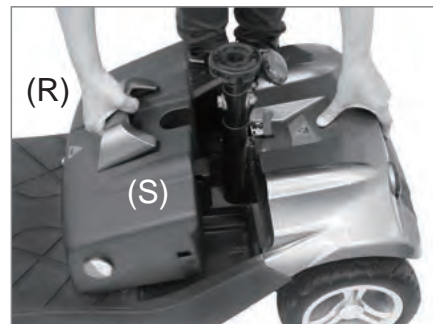

3. Front and Rear Frame Disassembling :

Hold front & rear frame with Release Lever (T) to disassemble front and rear frame.



Tiller Fold Method :

Turn the Cap (I) to fold down the Tiller (U) to the lowest position as shown in Figure 18. When the Tiller (U) is in the lowest position it can be locked by the pin of tiller angle adjustment.

Competition of Disassembling :

The Scooter can be disassembled into 7 main parts as shown below.

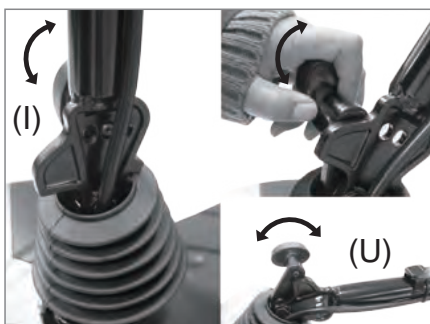

CAUTION : Re-assembling your scooter by vice versa above disassembling procedures.

Instruction Booklet: Troubleshooting

Flash	Description	Meaning
1	Battery Low	<p>The batteries are running low.</p> <ul style="list-style-type: none"> Recharge the batteries for a minimum of 12 hours.
2	Low Battery Fault	<p>The batteries have run out of charge.</p> <ul style="list-style-type: none"> Recharge the batteries.
3	High Battery Fault	<p>Battery voltage is too high. This may occur if overcharged &/or traveling down a long slope.</p> <ul style="list-style-type: none"> If traveling down a slope, reduce your speed to minimize the amount of regenerative charging. Check the battery and associated connections and wiring.
4	Current Limit Time-Out	<p>The motor has been exceeding its maximum current rating for too long. This may be due to a faulty motor.</p> <ul style="list-style-type: none"> Check the motor and associated connections and wiring. Turn the controller off, leave for a few minutes and turn back on again.
5	Park Brake Fluid	<p>Either a park brake release switch is active or the park brake is faulty.</p> <ul style="list-style-type: none"> Check the park brake and associated connections and wiring. Ensure any associated switches are in their correct positions.
6	Throttle OONAPU	<p>The Throttle is out of neutral when turning the controller on.</p> <ul style="list-style-type: none"> Ensure the throttle is in neutral when turning the controller on. The Throttle may require re-calibration.
7	Speed Pot Fault	<p>The throttle, speed limit pot or their associated wiring may be faulty.</p> <ul style="list-style-type: none"> Check the throttle and speed pot and associated connections and wiring.
8	Motor Voltage Fault	<p>The motor or its associated wiring is faulty.</p> <ul style="list-style-type: none"> Check the motor and associated connections and wiring.
9	Other Error	<p>The controller may have an internal fault.</p> <ul style="list-style-type: none"> Check all connections & wiring.

Further issues:

If the above troubleshooting does not help to resolve the issue please contact the authorised dealer (page 2). Please have your serial no. to hand to provide to the authorised dealer, which can be found



Obstacle Climbing:

- Your scooter can climb obstacles and curbs of up to 40mm / 1.6" in height. Never attempt to overcome an obstacle when on an uphill or downhill gradient!
- Always approach obstacles straight on! Ensure that the front wheels and rear wheels move over the obstacle in one stroke, do not stop halfway!
- The maximum gap the scooter can drive over is 100mm / 4".
- When driving scooter on ramp, adjust body centre of gravity to keep scooter more safety.

Others:

- Charge the batteries after each trip. If the scooter is not used for some time, batteries may lose their charge. Batteries should be charged at least once a month.
- Check the battery gauge before driving to prevent power depletion.
- Batteries will have an aging phenomenon, where the storage capacity will gradually decrease. If batteries are damaged, please wrap them in a plastic bag and contact your local dealer for proper disposal.
- Do not disassemble battery and open sealed parts by yourself to prevent electric shock and burns from acid leakage.
- Adjust speed to a slow speed when starting off to prevent sudden acceleration.
- Never attempt to drive downhill backwards.
- Try not to drive scooter at night or in rain or bad weather.
- If storing your scooter for a long time (1 month or more), make sure that battery are fully charged, then disconnect the two batteries plugs (W), and store the scooter in a dry location.
- Front basket, weight capacity 3kgs (6.5lbs).

Instruction Booklet: Safety Information on Electronic Interference (EMI)

CAUTION: It is very important that you read this information regarding the possible effects of Electromagnetic Interference on your motorized scooter.

Powered wheelchairs and motorized scooters may be susceptible to electromagnetic interference (EMI), which is interfering electromagnetic energy (EM) emitted from sources such as radio stations, TV stations, amateur radio (HAM) transmitters, two-way radios, and cellular phones. The interference (from radio wave sources) can cause the motorized scooter to release its brakes, move by itself, or move in unintended directions. It can also permanently damage the motorized scooter control system. The intensity of the interfering EM energy can be measured in volts per meter (V/m). Each motorized scooter can resist EMI up to certain intensity. This is called its "immunity level." The higher the immunity level, the greater the protection. At this time, current technology is capable of achieving at least a 20 V/m immunity level, which would provide useful protection from the more common sources of radiated EMI. This immunity level of this motorized scooter model is 20 V/m.

There are a number of sources of relatively intense electromagnetic fields in the everyday environment. Some of these sources are obvious and easy to avoid. Others are not apparent and exposure is unavoidable. However, we believe that by following the warnings listed below, your risk to EMI will be minimized.

Tiller Angle Adjustment:

- Hand-held portable transceivers (transmitters-receivers) with the antenna mounted directly on the transmitting unit. Examples include: citizens band (CB) radios, "walkie talkie," security, fire, and police transceivers, cellular telephones, and other personal communication devices;

CAUTION: Some cellular telephones and similar devices transmit signals while they are ON, even when not being used.

- Medium-range mobile transceivers, such as those used in police cars, fire trucks, ambulances, and taxis. These usually have the antenna mounted on the outside of the vehicle; and
- Long-range transmitters and transceivers such as commercial broadcast transmitters (radio and TV broadcast antenna towers) and amateur (HAM) radios.

CAUTION: Other types of hand-held devices, such as cordless phones, laptop computers, AM/FM radios, TV sets, CD players, and cassette players, and small appliances, such as electric shavers and hair dryers, so far as we know, are not likely to cause EMI problems to your motorized scooter.

Motorized Scooter Electromagnetic Interference:

Because EM energy rapidly becomes more intense as one moves closer to the transmitting antenna (source), the EM fields from hand-held radio wave sources (transceivers) are of special concern. It is possible to unintentionally bring high levels of EM energy very close to the motorized scooter control system while using these devices. This can affect motorized scooter movement and braking. Therefore, the warnings listed below are recommended to prevent possible interference with the control system of the motorized scooter.

Warnings:

Electromagnetic interference (EMI) from sources such as radio and TV stations, amateur radio (HAM) transmitters, two-way radios, and cellular phones can affect motorized scooters. Following the warnings listed below should reduce the chance of unintended brake release or motorized scooter movement which could result in serious injury.

- Do not operate hand-held transceivers (transmitters-receivers), such as citizens band (CB) radios, or turn ON personal communication devices, such as cellular phones, while the motorized scooter is turned ON;
- Be aware of nearby transmitters, such as radio or TV stations, and try to avoid coming close to them;
- If unintended movement or brake release occurs, turn the motorized scooter OFF as soon as it is safe;
- Be aware that adding accessories or components, or modifying the motorized scooter, may make it more susceptible to EMI; and

CAUTION: There is no easy way to evaluate their effect on the overall immunity of the motorized scooter.

- Report all incidents of unintended movement or brake release to the distributor listed on the inside front cover of this manual. Note whether there is a source of EMI nearby.

Important Information:

- 20 volts per meter (V/m) is a generally achievable and useful immunity level against EMI (as of May 1994). The higher the level, the greater the protection.
- The immunity level of this product is 20 V/m.

Care and Maintenance

DAILY CHECK

Please always check your scooter before you start your every journey.

Check point	Inspection	What to do if the inspection is failed
N-D lever	Check for correct function	Contact your dealer.
Horn	Check for correct function	Contact your dealer.
Throttles	Pull the wigwag to test the scooter movement	Contact your dealer.
Electro-mechanical brake and Emergency hand brake	Pull the wigwag a little bit and release it to test if brake works. If your scooter comes with emergency handbrake, please check it as well.	Contact your dealer.
Battery Gauge	Check if the battery gauge is displayed and whether it is at low power.	<ul style="list-style-type: none"> • Contact your dealer if battery gauge is not working. • Recharge the battery immediately if low
Rear mirror (s)	Check if the parts are clean and firmly tighten to the scooter and do not wobble.	<ul style="list-style-type: none"> • Clean up the dirt by damp cloth. • Tighten the screw or clamping stem that holds the mirror(s)
Lighting	Check if all lights, such as head lights, rear lights, and turn signal are functioning correctly.	Contact your dealer.

WEEKLY CHECK

Check point	Inspection	What to do if the inspection is failed
Speed Dial Knob	Check for correct function	Contact your dealer.
Armrests	Check if the parts are clean and firmly tighten to the scooter and do not wobble. Tighten the screw knob that holds the armrest.	Contact your dealer.
Wheels/Tires	Inflate the tire to the correct pressure and check that <ol style="list-style-type: none"> 1. Drive wheels rotate without wobbling. 2. Tire tread depth is not less than 0.5mm. 3. No foreign objects in tires. 	Contact your dealer.
Motor	Check for correct function	Contact your dealer.
Battery Charger	Check if the charger is functioning correctly and the batteries are charged.	Contact your dealer.

MONTHLY CHECK

Check point	Inspection	What to do if the inspection is failed
Seat / Upholstery	Check for movement and if it's worn	Contact your dealer.
Electronics	Check if all the battery cables and connectors are firmly tighten to the scooter	Contact your dealer.

Specification	
Overall Length	1120 mm / 44"
Overall Width	620 mm / 24.4"
Overall Height	935 mm / 36.8"
Front Wheels	225 mm / 9"
Rear Wheels	225 mm / 9"
Weight W/Batteries	47.31 kg / 104.3 lbs
Weight of Heaviest Piece	16.58 kg / 36.6 lbs
Max. Speed	6.4 kmph / 4 mph
Weight Capacity	136 kg / 300 lbs
Ground Clearance	52 mm / 2"
Grade Climbable	8 degree
Curb Climbable	40 mm / 1.6"
Turning Radius	1450 mm / 57.1"
Suspension	Rear
Brake	Electro-Mechanical
Seat Type	Swivel Lightweight Foldable Seat
Seat Width	460mm / 18"
Motor Size	250W 4000 r.p.m
Battery Size	(1) 25.2V. 30.15Ah
Battery Weight	7 kg / 15.4 lbs
Travel Range	Up to 40kms / 25 Miles
Battery Charger	4A Off Board
Electronics	On I Off Key Switch, Battery Level Indicator, Speed Control Knob

Subject to change without notice. (Rev. 4, 2023/01/11)

Instruction Booklet: Warranty

There is a comprehensive twelve-month warranty from the date on which your new scooter is delivered. The warranty covers the scooter for repairs or replacement during this period. For more details, please see the Warranty Conditions below.

Warranty Conditions:

- Any work or replacement part installation must be carried out by an authorised service agent.
- To apply to warranty should your scooter require repair, please contact the authorised dealer.
- Should any part of the scooter require repair or full or part replacement, as a result of a manufacturing or material defect within warranty period, the work will be carried out by free of charge. Warranty period:
 1. Frame: 2 year limited warranty.
 2. Electronic parts: 12 months limited warranty.
 3. Batteries: 6 month limited warranty.
- Any repaired or replaced parts will be covered by this warranty for the balance of the warranty period on the scooter.
- Parts replaced after the original warranty has expired will be covered by a three months warranty.
- Consumable items supplied will not generally be covered during the normal warranty period unless such items require repair or replacement clearly as a direct result of a manufacturing or material defect.
Such items include (among others): upholstery, tyres and batteries.
- The above warranty conditions apply to brand new scooters purchased at the full retail price. If you are unsure whether your scooter is covered, check with the authorised dealer.
- Under normal circumstances, no responsibility will be accepted where the scooter has failed as a direct result of:
 1. The scooter part not having been maintained in accordance with the manufacturer's recommendations.
 2. Failure to use the manufacturer's specified parts.
 3. The scooter or part having been damaged due to neglect, accident or improper use.
 4. The scooter or part having been altered from the manufacturer's specifications or repairs having been attempted before the service agent is notified.

Please note your authorised dealer contact details on page 2. In the event of your scooter requiring attention, contact them and give all relevant details so they can act quickly.

The manufacturer reserves the right to alter, without notice, any weights, measurements or other technical data shown in this manual. All figures, measurements and capacities shown in this manual are approximate and do not constitute specifications.



